



TCM RADIANT BARRIER

ENERGY SAVING INSULATION FOR METAL ROOFS

Tri County Metals' TCM Radiant Barrier is one of the most cost effective energy saving products on the market today. As with other insulation types that just slow the movement of heat in the house, TCM Radiant Barrier blocks it from even getting into the house.

TCM Radiant Barrier is perfect for re-roofing with metal or for new construction. Tri County Metals' TCM Radiant Barrier reflects up to 97% of radiant heat from the sun which accounts for a lot of the heat gain, thus keeping attic temperatures lower and therefore reducing cooling costs.





TCM Radiant Barrier is 3/8" thick, multi-layer, reflective insulation available in a 500 square foot roll.

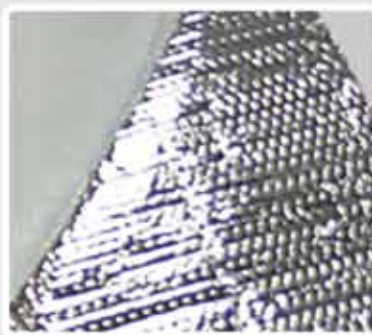

The outer layer of reflective material reflects up to 97% of radiant heat. Each reflective surface is bonded to a tough layer of polyethylene for strength.

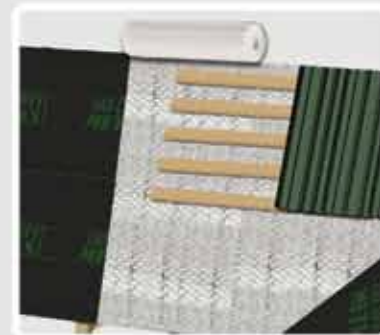

Two inner layers of insulating bubble pack resist conductive heat flow while a center layer of polyethylene gives TCM Radiant Barrier its high reliability and strength.

BENEFITS

- Lowers cooling costs
- Reduces the transfer of heat from your attic to your living spaces
- Increases the comfort level of your home
- Very easy to install
- Goes on quickly
- Extends the life of your air conditioner

TCM RADIANT BARRIER IS

SAFE TO USE

- No special tools required
- No breathing apparatus required
- Non-toxic / non-carcinogenic
- Clean and lightweight; easy to handle
- Doesn't promote the growth of fungi or bacteria
- Provides no nest support for rodent or insect pests
- Maintenance Free

SPECIFICATIONS

- Roll Width 4' x 125'
- 3/8" thick
- 36 lbs per roll
- 500 sq ft per roll

HOW IT IS INSTALLED

1. Pre-cut lengths of TCM Radiant Barrier that span eave-to eave, up and over the ridgeline.
2. Begin at one eave by laying the TCM Radiant Barrier flat on the roof. Unroll toward the ridge and continue down to the other side.
3. Lay the next course of Reflective Insulation parallel to the first.
4. Seal the joints and make sure the entire roofline is covered with TCM Radiant Barrier .
5. Attach 1 x 4 purlins over the TCM Radiant Barrier .
6. Install the metal roof on the purlins.

WARNING:

To ensure proper ventilation, vents (ridge, gable, soffit, etc) should not be covered by TCM Radiant Barrier.

